

VICINITY MAP
 NOT TO SCALE

NOTES:
 1) Solid portion of this addition by means and bounds is a violation of City, State and State law, and is subject to fines and/or withholding of title and other penalties.

- ABBREVIATION LEGEND**
- LP LIGHT POLE SET WITH SHINER STAMPED
 - MAG W.A.L. P.P. U.S. 5714"
 - MANHOLE
 - MIH
 - MP METAL POST
 - PLS PINE STRIP LINES
 - PF PINE FLAG
 - PKS PKNAIL SET
 - PM PAINT MARK
 - PS SIGNAL BOX
 - SP SIGNAL POLE
 - SS SHINER STAMPED
 - TKM TELEPHONE MARKER
 - TRM TRANSFORMER
 - USA TRANSPOSITION
 - W WATER
 - WP WATER PIPING
 - WV WOOD POST
 - X-CUT IN CONCRETE SET
 - XCS W/ALUMINUM CONCRETE SET
 - IRCP REINFORCED CONCRETE PIPE
 - IRN IRON ROD FOUND
- ABBREVIATION LEGEND**
- ABR DEFINITION
 - BELB BELLSHIELD
 - CB COMMUNICATION
 - CC COUNTY CLERK'S FILE NO.
 - CRS IRON ROD SET W/CAIP STAMPED W.A.L.
 - CM CLEANOUT
 - EB ELECTRIC BOX
 - EM FIRE HYDRANT
 - FM FIRE MARKER
 - FP FIBER OPTIC MARKER
 - G GAS
 - GL GAS METER
 - GR GAS RISER
 - GW GUY WIRE
 - H-HI HANGING HEIGHT
 - ICV IRRIGATION CONTROL VALVE
 - IRF IRON ROD FOUND

LINE TABLE

LINE #	BEARINGS	DISTANCE
L1	N89°42'47"E	151.4
L2	N04°1'20"W	54.2
L3	S44°40'16"W	179.1
L4	N40°03'03"W	130.0
L5	N44°54'07"E	100.0
L6	S09°39'35"E	130.0

CURVE TABLE

NO.	DELTA	RADIUS	LENGTH	CH. L.	CH. B.
C1	89°24'11"	200.0'	31.38'	28.29'	889'40'16"W
C2	90°00'00"	200.0'	31.42'	28.29'	N00°18'44"W
C3	89°47'08"	200.0'	31.34'	28.27'	S00°13'18"E
C4	90°1'22'00"	200.0'	31.49'	28.34'	S89°46'49"W

ABBREVIATION LEGEND

- LP LIGHT POLE SET WITH SHINER STAMPED
- MAG W.A.L. P.P. U.S. 5714"
- MANHOLE
- MIH
- MP METAL POST
- PLS PINE STRIP LINES
- PF PINE FLAG
- PKS PKNAIL SET
- PM PAINT MARK
- PS SIGNAL BOX
- SP SIGNAL POLE
- SS SHINER STAMPED
- TKM TELEPHONE MARKER
- TRM TRANSFORMER
- USA TRANSPOSITION
- W WATER
- WP WATER PIPING
- WV WOOD POST
- X-CUT IN CONCRETE SET
- XCS W/ALUMINUM CONCRETE SET
- IRCP REINFORCED CONCRETE PIPE
- IRN IRON ROD FOUND

ABBREVIATION LEGEND

- ABR DEFINITION
- BELB BELLSHIELD
- CB COMMUNICATION
- CC COUNTY CLERK'S FILE NO.
- CRS IRON ROD SET W/CAIP STAMPED W.A.L.
- CM CLEANOUT
- EB ELECTRIC BOX
- EM FIRE HYDRANT
- FM FIRE MARKER
- FP FIBER OPTIC MARKER
- G GAS
- GL GAS METER
- GR GAS RISER
- GW GUY WIRE
- H-HI HANGING HEIGHT
- ICV IRRIGATION CONTROL VALVE
- IRF IRON ROD FOUND

ABBREVIATION LEGEND

- LP LIGHT POLE SET WITH SHINER STAMPED
- MAG W.A.L. P.P. U.S. 5714"
- MANHOLE
- MIH
- MP METAL POST
- PLS PINE STRIP LINES
- PF PINE FLAG
- PKS PKNAIL SET
- PM PAINT MARK
- PS SIGNAL BOX
- SP SIGNAL POLE
- SS SHINER STAMPED
- TKM TELEPHONE MARKER
- TRM TRANSFORMER
- USA TRANSPOSITION
- W WATER
- WP WATER PIPING
- WV WOOD POST
- X-CUT IN CONCRETE SET
- XCS W/ALUMINUM CONCRETE SET
- IRCP REINFORCED CONCRETE PIPE
- IRN IRON ROD FOUND

ABBREVIATION LEGEND

- ABR DEFINITION
- BELB BELLSHIELD
- CB COMMUNICATION
- CC COUNTY CLERK'S FILE NO.
- CRS IRON ROD SET W/CAIP STAMPED W.A.L.
- CM CLEANOUT
- EB ELECTRIC BOX
- EM FIRE HYDRANT
- FM FIRE MARKER
- FP FIBER OPTIC MARKER
- G GAS
- GL GAS METER
- GR GAS RISER
- GW GUY WIRE
- H-HI HANGING HEIGHT
- ICV IRRIGATION CONTROL VALVE
- IRF IRON ROD FOUND

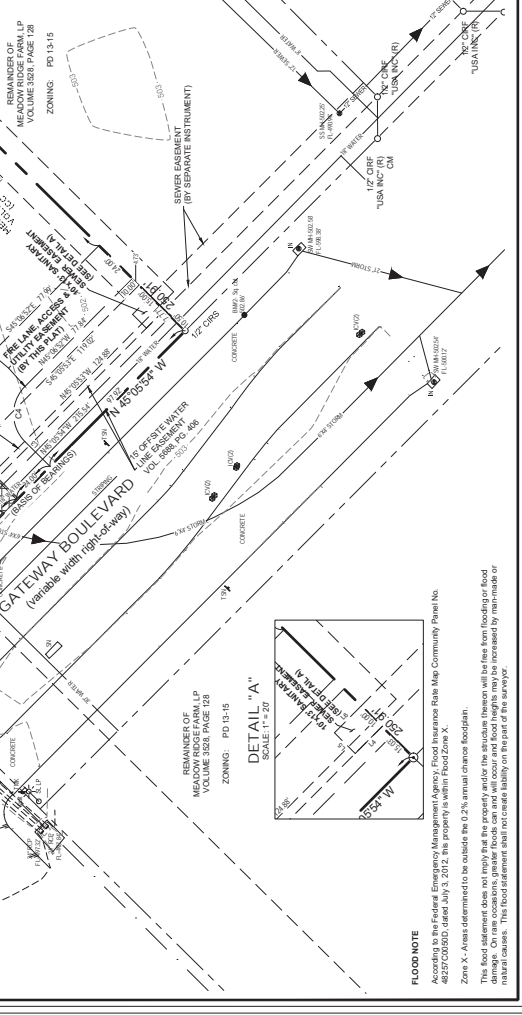

FLOOD NOTE
 According to the Federal Emergency Management Agency's Flood Insurance Rate Map, Community Panel No. 49277C090D, dated July 3, 2012, the property is within Flood Zone X.
 Zone X: Areas determined to be outside the 0.2% annual chance floodplain.
 The flood statement does not imply that the property and/or the structures thereon will be free from floodgout or flood damage. On rare occasions, greater floods can and will occur and flood heights may be increased by man-made or natural causes. This flood statement is not a complete study on the part of the surveyor.

